

ROTARY MOWERS  
FLAIL CHOPPERS



Symbol of Perfection



## Series T • Extra low models

All "Perfect" Rotary Mowers comply with the highest level of current requirements in modern orchards and vineyards. In order to prevent damage to low hanging branches and fruit our T-models have a low, streamlined profile and round sides.

Either one or two front support wheels and rear rollers give the necessary stability and excellent terrain adjustment. All generously overlapping cutting blades are driven indirectly by means of V-belts, mostly with automatic spring-loaded belt tensioners. This flexible drive system protects the gearbox from shock loads.

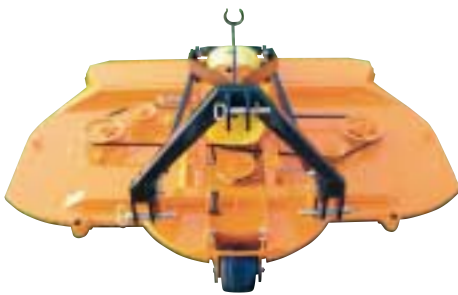

Specifications		T-155	T-180	T-200	T-225	T-250	T-290
Cutting width	cm/inch	155 / 5'1"	180 / 5'11"	200 / 6'7"	225 / 7'5"	250 / 8'2"	290 / 9'6"
Minimum power required at 540 rpm of pto	kW/HP	16 / 22	18 / 25	22 / 30	26 / 35	29 / 40	33 / 45
Number of blades		3	3	3	3	3	3
Total width	cm/inch	160 / 5'3"	185 / 6'1"	205 / 6'9"	230 / 7'7"	255 / 8'4"	295 / 9'8"
Cutting height	cm/inch	4-10 / 1'½-4	4-10 / 1'½-4	4-10 / 1'½-4	4-10 / 1'½-4	4-10 / 1'½-4	4-10 / 1'½-4
Length of rear roller(s)	cm/inch	(1) 102 / 40"	(2) 38 / 15"	(2) 48 / 19"	(2) 53 / 21"	(2) 53 / 21"	(2) 53 / 21"
Weight	kg/lbs	280 / 615	305 / 670	330 / 725	370 / 815	380 / 840	450 / 990

## Series RN • Twin gearbox models



Two separate gearboxes rotating in opposite directions drive the two main blades of our RN-mowers. This improves the cutting quality, even in higher grass.

The short central blade is placed in front of the two others which creates a generous overlap, giving a perfect, integral cut without striping. Working very closely behind the tractor and being fitted with front swivels wheels and a conical ended rear roller means the mower can very easily be manoeuvred, even if room is limited, without damaging the turf.

The RN can be delivered with a manual or hydraulic offset device, which allows work closer to the trees while keeping the tractor as central as possible between the tree rows.

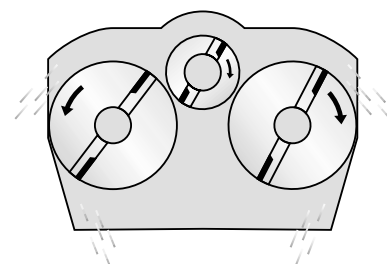

The cut material is evenly distributed behind the machine over its full working width or can, if required, be spread to the left and right hand side of the machine on the tree strips.

Specifications		RN-180	RN-200	RN-225	RN-250	RN-290
Cutting width	cm/inch	180 / 5'11"	200 / 6'7"	225 / 7'5"	250 / 8'2"	290 / 9'6"
Minimum power required at 540 rpm of pto	kW/HP	18 / 25	22 / 30	26 / 35	29 / 40	33/45
Number of blades		3	3	3	3	3
Total width	cm/inch	185 / 6'1"	205 / 6'9"	230 / 7'7"	255 / 8'4"	295 / 9'6"
Cutting height	cm/inch	4-10 / 1'½-4	4-10 / 1'½-4	4-10 / 1'½-4	4-10 / 1'½-4	4-10 / 1'½-4
Length of rear roller	cm/inch	48 / 19"	48 / 19"	48 / 19"	76 / 30"	95 / 37"
Maximum offset from centre of tractor (optional)	cm	26 / 4'2"	136 / 4'6"	148 / 4'10"	161 / 5'3"	-
Weight	kg/lbs	330 / 725	355 / 780	400 / 880	410 / 900	450 / 990



## Series LF • Skid Models

Our LF-type Rotary Mowers have long, rounded skids at both sides to allow for fast working speeds (up to 8-10 km/h = 6-6½ mph). The simple but very sturdy construction of these machines makes them ideal for grass cutting in orchards and vineyards, as well as for maintenance of estates, airfields, parks, camping sites etc.

An optional rear roller with conical ends can be used for extra stability.

Our LF mowers (except LF-140) have a simple offset possibility as standard. A parallelogram-type offset feature (with manual or hydraulic adjustment) is available as an optional extra.

Specifications		LF-140	LF-185	LF-215	LF-245	LF-275	LF-365
Cutting width	cm/inch	140/4'7"	185/6'1"	215/7'1"	245/8'1"	275/9'0"	365/12'0"
Minimum power required at 540 rpm of pto	kW/HP	16/22	18/25	22/30	26/35	29/40	33/45
Number of blades		2	2	3	3	3	4
Total width	cm/inch	149/4'11"	194/6'4"	224/7'4"	254/8'4"	284/9'4"	374/12'3"
Cutting height	cm/inch	4-14	4-14	4-14	4-14	4-14	4-14
Length of rear roller	cm/inch	53/21"	53/21"	95/37"	95/37"	95/37"	162/64"
*Max. Offset** →	cm/inch	-	140/4'7"	155/5'1"	170/5'7"	185/6'1"	230/7'7"
*Max. Offset parall.** ↔	cm/inch	-	133/4'4"	148/4'10"	163/5'4"	178/5'10"	223/7'4"
Weight	kg	325/715	345/760	385/850	405/890	470/1030	550/1210

\* Optional \*\* From centre of tractor The cutting height is adjustable to 4-14 cm / 1½-5½ inch



LF with a parallelogram-type offset (optional)



## Series RF • Rotary Mowers with swinging arm

The labour saving "Perfect" swing arm has been developed to make mowing between and around tree trunks easier whilst avoiding damage to the trees. When the rubber surround of the swing arm touches the trunk, the wheel rotates and deflects the swinging arm and its cutting blade away from the tree. As soon as the spring-loaded swinging arm has passed the tree it automatically returns to its original position.

For young trees or when operating on inclines the swinging arm can be provided with a hydraulic feeler mechanism. The parallelogram headstock with manual, or if desired hydraulic adjustment allows for a very large offset of the machine. Our RF-models are also very successfully used as fence mowers to cut grass under board fences, along wire or rock fences and around fence posts.

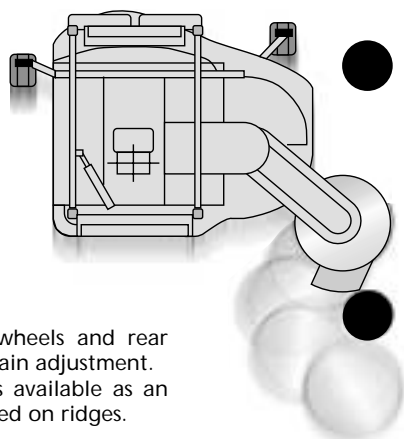

The two front swivel wheels and rear roller give a perfect terrain adjustment. A raisable swing arm is available as an option if trees are planted on ridges.

Specifications		RF-220	RF-270	RF-300	RF-340
Cutting width	cm/inch	220/7'3"*	270/8'10"*	300/9'10"*	340/11'2"*
Minimum power required at 540 rpm of pto	kW/HP	20/28	26/35	29/40	33/45
Number of blades		2 + 1	3 + 1	3 + 1	4 + 1
Cutting height	cm/inch	4-10 / 1½-4	4-10 / 1½-4	4-10 / 1½-4	4-10 / 1½-4
Length of rear roller	cm/inch	53	53	53	117
Maximum offset from centre of tractor	cm/inch	215*	230*	255*	297*
Weight	kg/lbs	410	485	515	575

\* without swing arm less 55 cm = 21"

## Series DR • Variable width mowers with wings

Our "Perfect" variable width mowers consist of a rigid central section with an adjustable wing mounted on either side. The wings are operated by hydraulic rams which move smoothly and independently open and closed, to allow for an easy and exact adjustment of the cutting width in orchards and vineyards with different row widths.

Two gearboxes rotating in opposite directions assure an excellent throw out and distribution of the cut material either behind the machine or to the left and right hand side on the tree strips.

The central section has two front swivel wheels and a rear roller, the wing sections have support saucers fitted with bearings.

There is a small amount of float on the wings to allow for undulating ground. For ground that is seriously undulating or not level with the central alley, raisable wings are available as an option.



DR

## Series MD • Double swing arm mowers

*Instead of wings the central section of our variable width mowers can be fitted with a swinging arm on either side. This enables the central grass alley to be cut as well as the area around the tree.*

Specifications	DR with 2 wings	DR-250	DR-280	-	DR-320	-	DR-365	-	DR-440	DR-570
	MD with 2 swing arms	MD-250	MD-280	MD-300	-	MD-335	-	MD-400	-	-
Minimum cutting width	cm/inch	170 / 5'7"	175 / 5'9"	190 / 6'3"	190 / 6'3"	225 / 7'5"	225 / 7'5"	294 / 9'8"	294 / 9'8"	294 / 9'8"
Maximum cutting width	cm/inch	250 / 8'3"	280 / 9'2"	300 / 9'10"	320 / 10'6"	335 / 11'0"	365 / 12'0"	400 / 13'1"	443 / 14'6"	570 / 18'8"
Minimum power required at										
540 rpm of pto	kW/HP	28 / 38	29 / 40	33 / 45	36 / 50	38 / 52	40 / 55	45 / 62	48 / 65	52/70
Number of blades		4	5	5	5	5	5	5	5	7
Total width	cm/inch	161 / 5'3"	178 / 5'10"	193 / 6'4"	193 / 6'4"	228 / 7'6"	228 / 7'6"	300 / 9'10"	300 / 9'10"	300 / 9'10"
Cutting height	cm/inch	4-9 / 1'½-3'½	4-9 / 1'½-3'½	4-9 / 1'½-3'½	4-9 / 1'½-3'½	4-9 / 1'½-3'½	4-9 / 1'½-3'½	4-9 / 1'½-3'½	4-9 / 1'½-3'½	4-9 / 1'½-3'½
Weight	kg/lbs	495 / 1090	535 / 1175	560 / 1230	600 / 1320	590 / 1300	620 / 1365	675 / 1485	725 / 1595	805 / 1775

## Optional Extras • Optional Extras • Optional Extras



### Swing-Away blades

The generously overlapping cutting blades are made from special alloy spring steel and have double cutting edges for 100% longer life. Our machines can be fitted with swing-away blades to give additional protection in rough or stony conditions. *Optional extra on all "Perfect" rotary mowers; standard on the Solo-Swing.*

### Mow-spray combination

Mowing and spraying at the same time helps save time and labour costs. The unique "Perfect" mow-spray frame has been designed so that both the front (1) and the rear (2) of the mower is able to move freely from the headstock. This system transmits the full bearing pressure of the sprayer to the tractor 3-point linkage therefore not loading the mower in any way. The mow-spray combination feature is also available with a disconnectable gearbox to take the drive away from the mower blades, if wanted. *Optional extra on models T, RN and DR.*



## Series LK • Gear drive rotary mowers



The rotary mowers series LK have been designed for use in parcels where the grass is cut less frequently.

The cutting blades of these mowers are not driven by V-belts, but directly from the gearboxes.

The flexible rubber shock absorber(s) between the gearboxes and the standard pto shaft with overrunning clutch and overload protection clutch, protect the drive line.

Specifications		LK-140	LK-160	LK-185	LK-215	LK-245	LK-275
Cutting width	cm/inch	140 / 4'7"	160 / 5'3"	185 / 6'1"	215 / 7'1"	245 / 8'1"	275 / 9'0"
Minimum power required at 540 rpm of pto	kW/HP	26/35	30/40	37/50	41/55	45/60	56/75
Number of blades		2	2	2	2	3	3
Total width	cm/inch	150 / 4'7"	170 / 4'7"	195 / 4'7"	225 / 4'7"	255 / 4'7"	285 / 4'7"
Cutting height	cm/inch	4-14 / 1 1/2-5 1/2	4-14 / 1 1/2-5 1/2	4-14 / 1 1/2-5 1/2	4-14 / 1 1/2-5 1/2	4-14 / 1 1/2-5 1/2	4-14 / 1 1/2-5 1/2
Max offset from centre of tractor	cm/inch	97 / 3'2"	107 / 3'6"	141 / 4'7"	156 / 5'1"	171 / 5'7"	186 / 6'1"
Weight	kg/lbs	470 / 970	500 / 1100	565 / 1245	625 / 1375	645 / 1420	710 / 1565

## Optional Extras • Optional Extras • Optional Extras •

### Front mounted mowers

A front mounted mower gives the advantage of the grass being cut before the tractor wheels have run over it and it also provides a better view of the work. The cantilever design headstock enables the front linkage mounted version of the "Perfect" mowers to be pulled rather than pushed. This protects the machine and provides a full floatation effect.

*An additional headstock is available for front and rear mounted use when different tractors are used.*

Tractor pto 540 rpm or 100 rpm as desired.

*Optional extra on series T, RN, LF and DR.*



### Tandem roller

The tandem rear roller increases the bearing surface and spreads the ground pressure more evenly which gives the machine a smooth run. Especially under humid working conditions and in the case of mow-spray combination the tandem roller protects the ground structure.



## Flail Choppers • Series BG2 and BK2

Because of their low and compact but heavy construction our Flail Choppers Series BG2 and BK2 are very popular for chopping orchard- and vineyard prunings up to 10 cm (4") diameter.

They are fitted with a parallelogram-type offset feature as standard. Their profile is very low: the height of the V-belt cover is only 51 cm (20"). The flail rotor bearings are mounted inside the frame, which means that the ratio of cutting width to overall width is maximised.



BG2

### Specifications

BG2 - standard		BG2-120	BG2-135	BG2-150	BG2-180	BG2-210	
BK2 - with rake tines		BK2-105	BK2-120	BK2-135	BK2-150	BK2-180	BK2-210
Cutting width	cm/inch	105 / 3'5"	120 / 3'11"	135 / 4'5"	150 / 4'11"	180 / 5'11"	210 / 6'11"
PTO speed	rpm	540	540	540	540	540	540
Flail rotor speed	rpm	2100	2100	2100	2100	2100	2100
Min. power* required 540 rpm							
• grass cutting etc.	kW/HP	18/25	18 / 25	20 / 27	22 / 30	26 / 35	28 / 38
• brush chopping etc.	kW/HP	22/30	26 / 35	27 / 37	30 / 40	33 / 45	38 / 52
Flails 2.2 kg = 5 lbs (0,8 kg = 1¾ lbs)		6 (12)	8 (12)	8 (16)	9 (16)	12 (20)	12 (20)
Total width	cm/inch	125 / 4'1"	142 / 4'8"	155 / 5'1"	170 / 5'7"	200 / 6'7"	230 / 7'7"
Height of belt cover	cm/inch	51½ / 20"	51½ / 20"	51½ / 20"	51½ / 20"	51½ / 20"	51½ / 20"
Tractor 3 pt. linkage	cat	I + II	I + II	I + II	I + II	I + II	I + II
Maximum offset from centre of tractor	cm/inch	65 / 2'2"	80 / 2'7"	95 / 3'1"	110 / 3'7"	140 / 4'7"	170 / 5'7"
Weight BG2	kg/lbs	-	515 / 1145	540 / 1200	565 / 1255	615 / 1367	665 / 1478
Weight BK2	kg/lbs	515 / 1135	545 / 1211	575 / 1278	600 / 1333	652 / 1449	707 / 1571
Number of rake tines BK2		8	9	9	11	13	15

\* Power requirements depend entirely on the type of work

For a better pick-up and pulverization of thin prunings or prunings that are laying flat, our flail choppers **Series BK2** are delivered with rake tines which are adjustable in height.

The gearbox with spiral toothed gears and the V-belts with a springloaded automatic belt tensioner assure an indirect flexible drive with maximum security and a minimum maintenance. A full width rear roller with conical ends and skids at both sides provides excellent stability and easy handling.



BK2

## Optional Extras • Optional Extras • Optional Extras

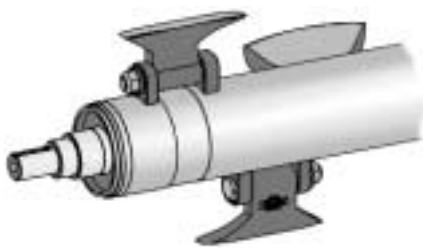

Flail 2,2 kg = 5 lb

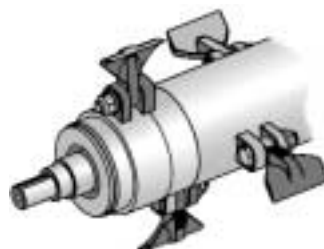

Flail 0,8 kg = 1¾ lb

### Flails

The 2,2 kg (5 lbs) heavy-duty "Perfect" flails are especially designed for pulverizing prunings. They are fitted to the electronically balanced vibration-free flail rotor with heavy bolts and replaceable steel bushings and provide an excellent pulverization. No further work is necessary to collect or remove the cut material.

Optional flails of 0,8 kg (1¾ lbs) are available for grass cutting and light chopping work (vineyard prunings, leaves etc.).

## Heavy-Duty Flail Choppers • Series KG and KK

The "Perfect" flail chopper line also includes two larger capacity machines in cutting widths of 220 cm (7'3") and 245 cm (8'1"), which are designed to deal with heavier working conditions, not only for chopping prunings up to 10 cm (4") diameter but also for other vegetation residues such as corn stalks etc.

Because of the bigger size reinforced flail rotor and gearbox the V-belt cover on these machines is somewhat higher, measuring 72 cm (28") on the KG/KK-220 and 77 cm (30") on the KG/KK-245HD.

Our heavy-duty flail choppers **series KK** are delivered with an adjustable rear opening cover and with optional rake tines.



Models KG/KK-245HD have a heavier frame, a heavy-duty pto shaft and gearbox as well as a flail rotor and rear roller of increased diameter.

### Specifications

KG - standard		KG-220	KG-245HD
KK - with rear rake option		KK-220	KK-245HD
Cutting width	cm/inch	220 / 7'3"	245 / 8'1"
PTO speed	rpm	540	540
Flail rotor speed	rpm	2100	2100
Min. power* required 540 rpm			
• grass cutting etc.	kW/HP	30 / 40	44 / 60
• brush shopping etc.	kW/HP	44 / 60	58 / 80
Flails 2.2 kg = 5 lbs (0,8 kg = 1 3/4 lbs)		12 (24)	16 (-)
Total width	cm/inch	246 / 8'1"	274 / 9'0"
Height of			
belt cover	cm/inch	72 / 28"	77 / 30"
Tractor 3 pt. linkage	cat	I + II	I + II
Maximum offset from centre			
of tractor	cm/inch	182 / 6'0"	181 / 5'11"
Weight KG/KK	kg/lbs	695-745 / 1530-1640	925-980 / 2040-2160
Number of rake tines (optional on KK)		14	16

\* Power requirements depend entirely on the type of work

## Optional Extras • Optional Extras • Optional Extras •

### Front mounted flail choppers

A front mounted flail chopper can more easily deal with larger quantities of prunings because the tractor has not run over the prunings before chopping them. The unique cantilever design of the headstock enables the front mounted version of the "Perfect" flail chopper to be pulled rather than pushed. This protects the machine and provides a full floatation effect. By reversing the headstock our front mount models can also be used as rear mounted machines. Available for either 540 rpm or 1000 rpm of pto.

Option on models: KL, BG2 / BK2 and KG / KK



BK2-150 Frontmount



## Extra compact Flail Choppers • Series KL

Our KL-type flail choppers are compact, streamlined and very low construction (**over its entire width the height does not exceed 42 cm = 16"**). Nevertheless they perfectly pulverize prunings up to 7 cm = 2<sup>3</sup>/<sub>4</sub>" diameter.

They are designed for use with smaller size tractors (from 18kW = 25 hp), and are fitted with rear rake tines. KL-machines are also very popular with fruit and vegetable growers for cutting grass and for chopping leaves and other vegetation residues.

Specifications		KL-120	KL-135	KL-150
Cutting width	cm/inch	120 / 3'11"	135 / 4'5"	150 / 4'11"
PTO speed	rpm	540	540	540
Flail rotor speed	rpm	1900	1900	1900
Min. power* required 540 rpm				
• grass cutting etc.	KW/HP	18 / 25	20 / 27	22 / 30
• brush chopping etc.	KW/HP	26 / 35	27 / 37	30 / 40
Number of flails (2.2 kg = 5 lbs)		8	8	9
Total width	cm/inch	138 / 4'6"	153 / 5'0"	168 / 5'6"
Cutting height	cm/inch	1 1/2-8 1/2 / 3/8-3 3/8	1 1/2-8 1/2 / 3/8-3 3/8	1 1/2-8 1/2 / 3/8-3 3/8
Tractor 3 pt. linkage	cat	I + II	I + II	I + II
Maximum offset				
from centre of tractor	cm/inch	90 / 3'0"	105 / 3'6"	120 / 4'0"
Weight	kg/lbs	320 / 710	370 / 810	400 / 880
Number of rake tines		9	10	11

\* Power requirements depend entirely on the type of work



## Front and rear mounted flail choppers • Series BGM and BKM

The heavy constructed flail chopper series BGM and BKM have especially been designed for use by costumers disposing of different tractors to drive. The special headstock allows for use as front and as rear mounted models without any transformation.

The standard configuration also includes a hydraulic offset feature and a universal gearbox with integrated overrunning clutch that accepts any rotation.

The models BKM are equipped with rake tines as standard.

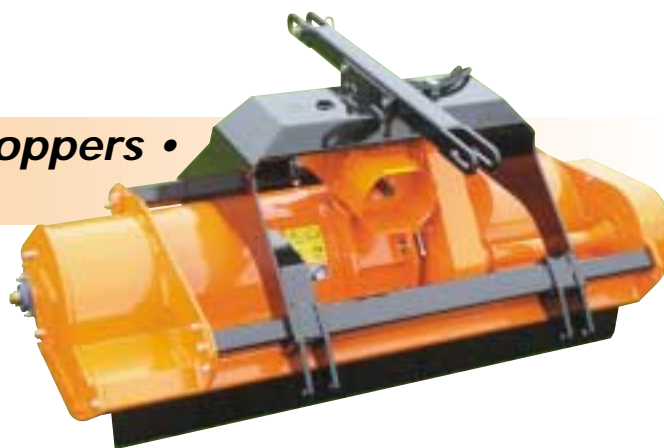

Specifications		BGM-150	BGM-180	BGM-210
BGM - standard				
BKM - with rake tines		BKM-150	BKM-180	BKM-210
Cutting width	cm/inch	150 / 4'11"	180 / 5'11"	210 / 6'11"
Min. power* required at 540 rpm of pto kW/HP		30/40	33/45	38/52
Max. offset from centre of tractor	cm/inch	99 / 3'3"	129 / 4'3"	159 / 5'3"
Flails 2.2 kg = 5 lbs (0,8 kg = 1 <sup>3</sup> / <sub>4</sub> lbs)		9 (16)	12 (20)	12 (20)
Overall width	cm/inch	170 / 5'7"	200 / 6'7"	230 / 7'7"
Weight BGM	kg/lbs	695 / 1530	745 / 1638	795 / 1450
Weight BKM	kg/lbs	730 / 1610	780 / 1720	835 / 1840
Number of rake tines BKM		11	13	15

\* Power requirements depend entirely on the type of work



The "Perfect" brush sweepers attachments and front mounted brush sweepers are designed to remove the prunings and leaf residues which are in the tree or vine rows and to clean the herbicided strips in order to discourage the development of fungus and to implement an optimal chemical weed control.

They are driven by a hydraulic motor and are equipped with elastic and highly resistant sweeper brushes which spin at approximately 150 rpm.

The sweeper head position is adjustable both in working angle and in working height, which assures a high quality working result in all conditions.

For perfect terrain adjustment the sweeper head is supported by a swivel wheel. In transport position the brush sweeper can be folded away manually or by means of a hydraulic ram.



Available on all "Perfect" flail choppers and for tractor front mount (1 or 2 sides).

The double front mounted brush sweeper clears the row in one pass from leaves, prunings etc. The working width is adjustable up to max. 400 cm (13'1") and in the standard configuration the machine is equipped with hydraulic rams to adjust the working width and to lift the sweepers.



Specifications		Single sweeper Attachment/Front	Double sweeper Front
Max. working width	cm/inch	depends on mounting position	400/13'1"
Oil flow	l/min.	30	30
Oil pressure	bar/PSI	±70 / 1015	±70 / 1015
Sweeper width	cm/inch	100 / 3'3"	2 x 100 / 3'3"
Necessary hydraulic couplings on the tractor		1 x double acting or 1 single acting and 1x free flow return	3 x double acting or 2 x double acting and 1 single acting + 1 x free flow return
Max. offset from centre of tractor	cm/inch	depends on mounting position	200 / 6'6"

## Solo Swing • Series SZF and SZL



The Solo-Swing is a swinging arm, driven by a hydraulic motor, to mow around trees, fences, posts etc.

The standard configuration is a tractor front mount version with hydraulic offset (SZF = short offset, SZL = long offset) and two support wheels. Available for pastures, paddocks, orchards, vineyards, etc.

All Solo-Swing versions have swing-away blades as standard.

The Solo-Swing comes automatically in transport position as soon as the swing arm is being retracted completely.

For optimal performance under different conditions the cutting height, as well as the working angle, float and swing-return pressure are easily adjustable.



## Solo Swing Attachment • Series SZA

The Solo-Swing is also available as an attachment with mounting brackets to be fitted to a rotary mower or a flail mower.



Technical specifications		SZF-600	SZL-600	SZA-600
Cutting width	cm/ft	60 / 2'0"	60 / 2'0"	60 / 2'0"
Oil flow	l/min	30	30	30
Oil pressure	bar/PSI	± 120 / 1740	± 120 / 1740	± 120 / 1740
Cutting height	cm/inch	4-12	4-12	4-12
Cutting angle		0°-15°	0°-15°	0°-15°
Discharge angle		0°-15°	0°-15°	0°-15°
Offset from tractor centreline:				
-maximum	cm/ft	165 / 5'5"	210 / 6'11"	
Tractor hydraulics required		1 x double acting valve 1 x single or double acting valve and 1 x free flow return	1 x double acting valve 1 x single or double acting valve and 1 x free flow return	1 x single or double acting valve and 1 x free flow return
Weight	kg/lbs	175 / 385	200 / 440	60 / 132



# VAN WAMEL B.V.



Energieweg 1 - P.O. Box 4  
6658 ZG Beneden-Leeuwen  
HOLLAND  
Tel. +31 (0)487 592944  
Fax +31 (0)487 592970  
E-mail perfect@vanwamel.nl  
Internet www.vanwamel.nl

Represented by: